



The DeltaPlex Arena & Conference Center

Contact:
Joel Langlois
President
2500 Turner Ave. NW
Grand Rapids, MI 49544
www.Deltaplex.com
Joel@Deltaplex.com

Introduction

The DeltaPlex Arena & Conference Center is located in Grand Rapids, Michigan. A very nice location located midway between Detroit and Chicago with easy access to three major freeways. Just minutes from downtown Grand Rapids, the arena is a 23,000 square foot space that seats up to 7,000 guests.

The arena is a comfortable, modern venue that can accommodate a variety of events, from professional sports to an “in-the-round” stage for a major concert. The arena is even capable of holding a three-ring circus! Its two exhibition halls and arena provide a variety of arrangements for trade show booths allowing up to 425 standard 8’x 10’ booths. With its new renovations The DeltaPlex is equipped to offer its clients with up-to-date amenities and conveniences, which includes onsite parking for up to 1,500 cars.

It’s never too early to start planning your next event. Enclosed is detailed information on The DeltaPlex facility. We invite you to visit the facility and book a date for an upcoming event. The DeltaPlex staff is committed to the highest standards of excellence and we look forward to hosting your event.

The DeltaPlex is West Michigan's fastest growing venue for Concerts, Exhibitions, Trade Shows, Business Meetings and Sporting Events. DeltaPlex rental fees are affordable and value packed and our professional staff can help you in all aspects of the production and promotion of your event. Acres of on-site parking can be found immediately adjacent to the complex.



DeltaPlex Contact List

Administrative Offices

616-364-9000

President

Joel Langlois
Joel@deltaplex.com

Event Director

Erin Bowen
Erin@deltaplex.com

Event Coordinator

Christine Welsh
Christine@deltaplex.com

Finance Manager

Kevin Dine
Kevin@deltaplex.com

Food and Beverage Manager

Lindsey Langlois
Lindsey@deltaplex.com

Operations Manager

Shirley Suttorp
Operations@deltaplex.com

Director of Event Development & Sales

Chris Hudson
Chris@deltaplex.com

Marketing Manager

Jeremy Quillan
Jeremy@deltaplex.com

Directions & Location

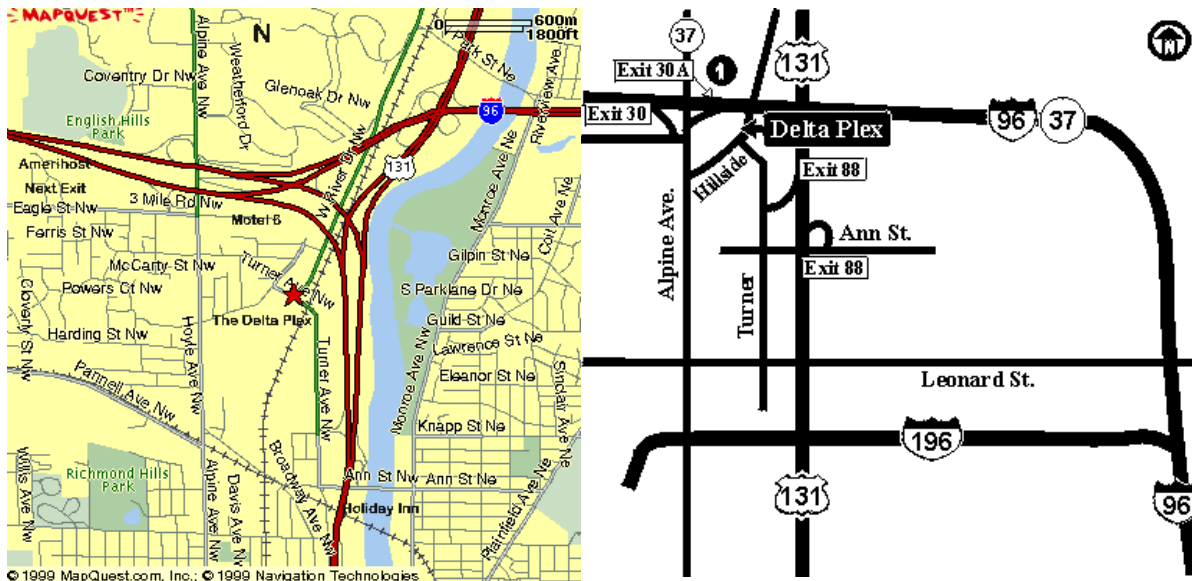

The DeltaPlex is located just minutes from downtown Grand Rapids. It is easily accessible from US-131, I-96, and I-196.

From the North

Take US-131 South to the Ann Street Exit (Exit 88) and turn Right at the light onto Turner Ave. Follow Turner for .5 miles to the DeltaPlex.

From the South

Take US-131 North to Ann Street (Exit 88) and turn right at the light onto Ann Street. Turn right at next light onto Turner and follow for 0.8 miles to the DeltaPlex.

From the West (on 96 East from Muskegon)

Take I-96 to US-131 South to Ann Street (Exit 88) and turn right at the light onto Turner Ave, follow about .5 miles to the DeltaPlex.

From the West (on I-196 East)

Take I-96 to US-131 North to Ann Street (Exit 88) and turn right at the light. Turn right at next light on Turner and follow for 0.8 miles to the DeltaPlex.

From the East (on I-196 West)

(The Gerald R. Ford Freeway) - Follow US-131 North (Exit 77) to Ann Street (Exit 88) and turn right at the light. Turn right at next light on Turner and follow for 0.8 miles to the DeltaPlex.

Overall Facility

- Size: 124,000 sq. ft.
- Land Size: 24 Acres, Parking for 1,500 Plus
- Renovated: 1998
- HVAC: 100% Air Condition, Arena Also Humidity Controlled
- Electrical: 2000 Amp 480v 3Phase, 208/Y & 120v
- Location: 2500 Turner Ave. NW – Grand Rapids, MI 49544
Within an hour drive from Kalamazoo, Battle Creek, Lansing, Holland, and Muskegon. (Markets to over 2 million people).
- Concessions: Professional Catering Available
In House Concessions Available
Liquor Licensed
- Loading Docks: 2 Centrally Located Loading Docks, 3 Drive In Doors

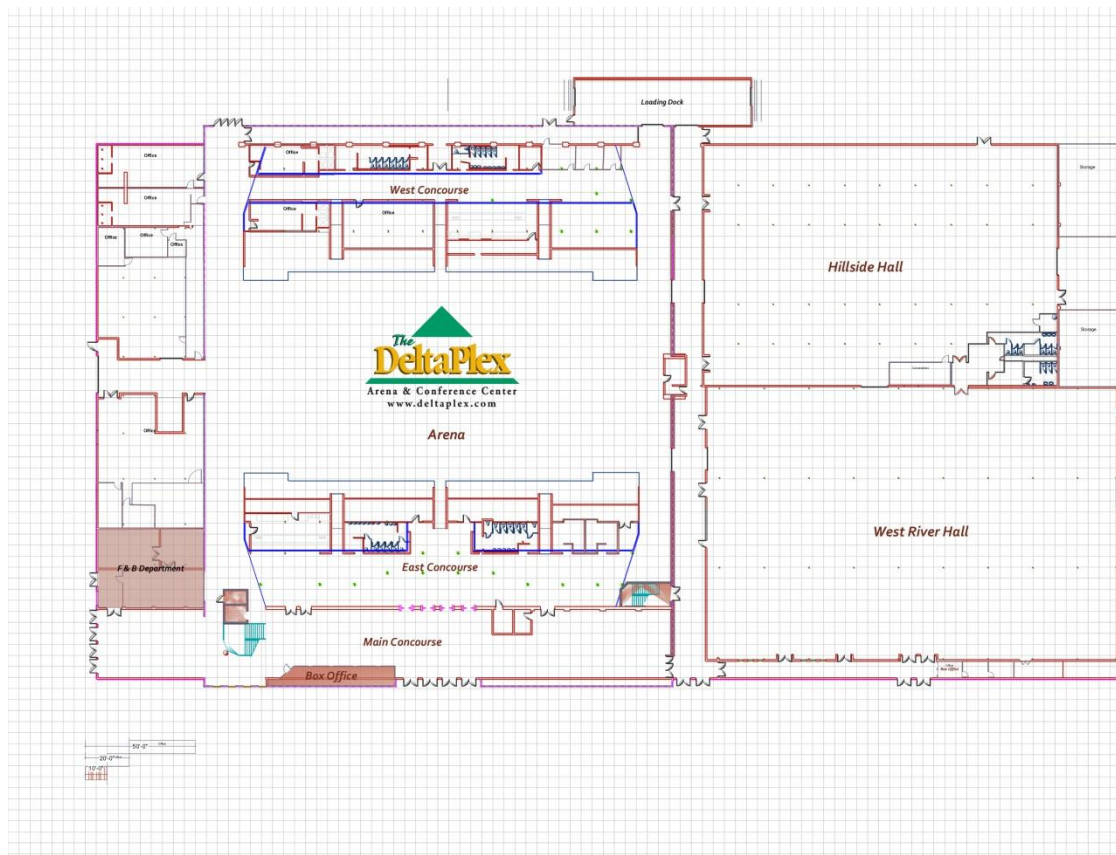



Arena

- Size: 20,000 sq. ft.
- Seating: 4,500 Fixed Seats, Can Configure Up To 7,000
- Floor: Concrete Multipurpose
- Ceiling Height: 52' Clear With Multiple Rigging Points
- Staging: 60' x 56' Portable with Multiple Heights
- Doors: 14' x 16' Drive In Door and 2 Loading Docks
- Lockers: 4 Permanent Lockers/ Dressing Rooms with Showers
- Ticket Area: 1 Ticket Booth with 4 Stations & 1 Ticket Booth with 2 Stations
- Concessions: 2 Permanent and 4 Portable

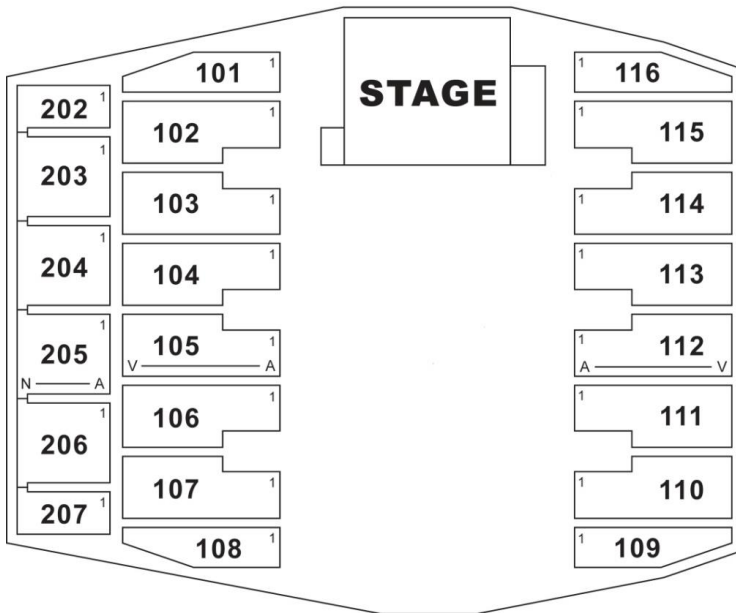



West River Hall

- Size: 24,000 sq. ft.
- Ceiling Height: 12' Clear and 14' Overall
- Doors: 14 Entry Doors, 1- 12 x 12 Drive In Door and 2 Loading Docks
- HVAC: 100% Air Conditioned
- Electrical: 480v, 280/Y and 1

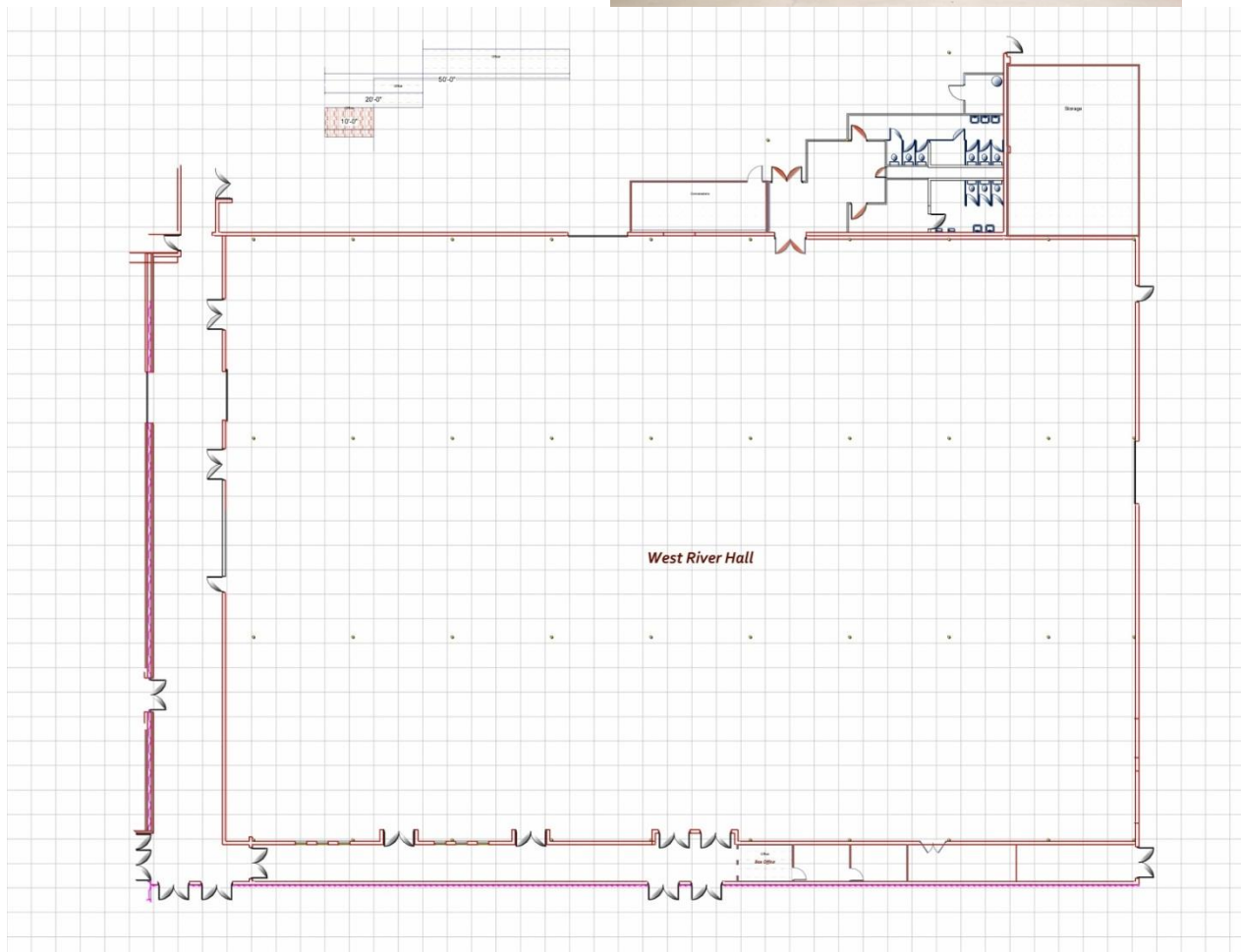

Hillside Hall

Size: 19,000 sq. ft.
Ceiling Height: 12' to 16' Clear
Doors: 10 Entry Doors, 1- 12' x 12' Drive In Door and 2 Loading Docks
HVAC: 100% Air Conditioned
Electrical: 480v, 280/Y and 120v

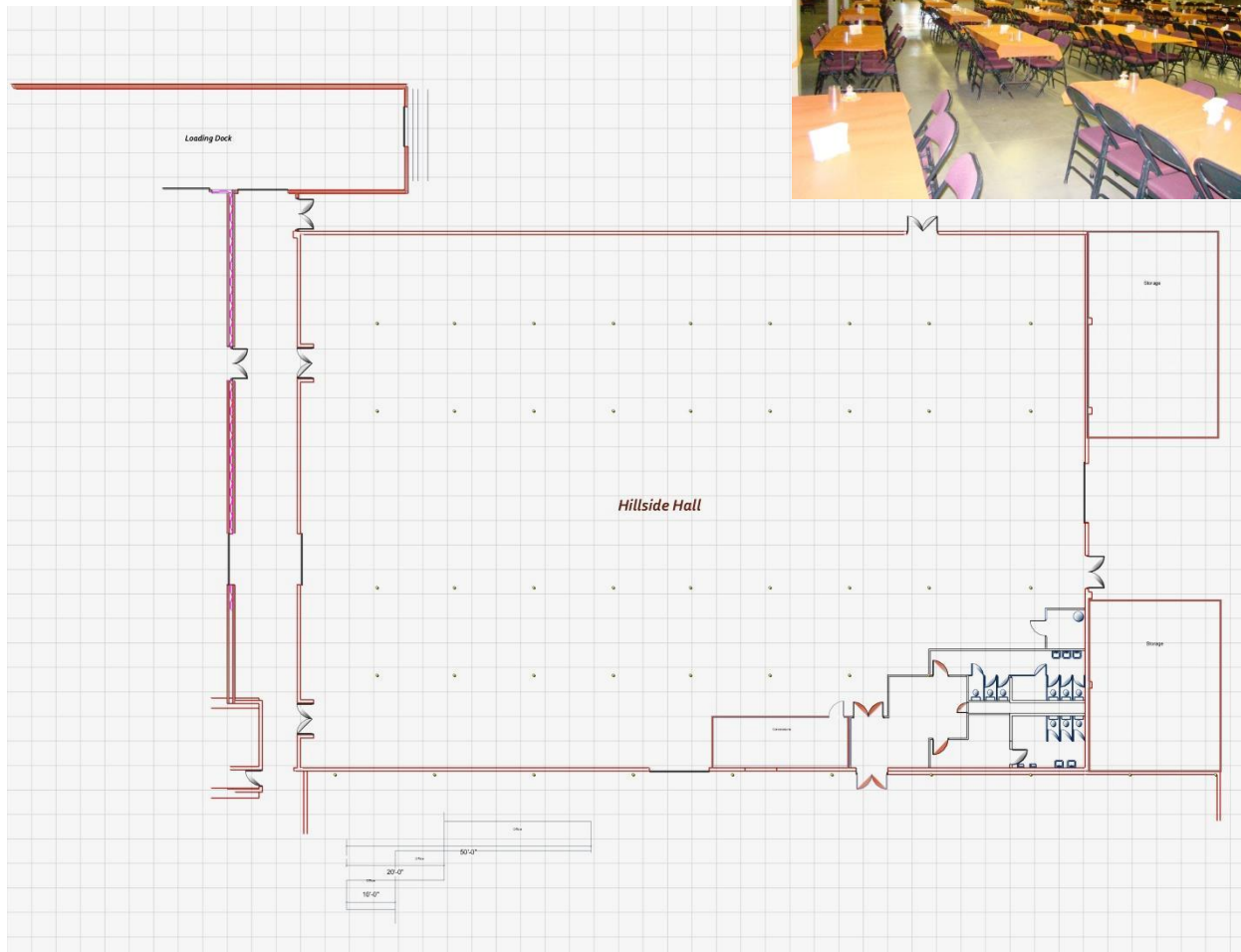

1st Floor

Open concourse area: 8,000 square feet

Ceiling: 12'



2nd Floor- Walker Ballroom

Size: 2,300 sq. ft.

Seating: Serves up to 225 People

Ceiling Height: 16' Clear

Doors: Standard Double Wide Doors

HVAC: 100% Air Conditioned

Electrical: 120v

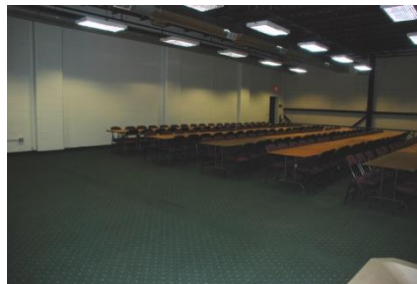
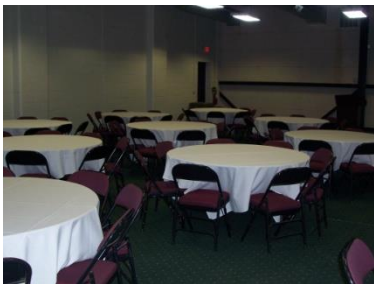

3rd Floor

Size: 6,000 square feet

Ceiling: 23'

Seating: Open area with pullout seating for arena

Rates

Room	Weekday (M – TH)	Weekend (Fri- Sun)
DeltaPlex Arena (20,000 sq ft)	\$3,500.00 or 10% of Gross Ticket Sales	\$3,750.00 or 10% of Gross Ticket Sales
Both Conference Rooms	\$3,900.00/day	\$4,200.00/day (Sept – May) \$3,900.00/day (June - Aug)
West River (23,000 sq ft)	\$2,300/day	\$2,550.00/day (Sept – May) \$2,300.00/day (June - Aug)
Hillside (17,000 sq ft)	\$1,800.00/day	\$2,000.00/day (Sept – May) \$1,800/day (June – Aug)
Concerts in Conference Room	Ask for Price	Ask for Price
Walker Ballroom	\$500.00/day	\$800.00/day
Concourse	\$750.00/day	\$1,000.00/day
Third Level Balcony	\$750.00/day	\$1,000.00/day



Equipment Rates

Equipment	Rental Rate	Rental Units
Bike Rack	\$10.00	each
Stage Barricade	\$10	foot
Car/Van	Per quote	
Chairs	\$0.50	each
Chairs, Padded	\$1.00	each
Condor	\$250.00	day
Cords	\$15.00	each
Dumpster	Per quote	
Electricity (110V)	\$40.00/advance order \$55.00/within 48hrs of event	each
Electricity (Higher volts or amp)	Refer to Electrical Order Form	
Fork Lift		
Hourly Use	\$50.00	Hour
Daily Use	\$250.00	Daily
Operator	\$35.00	hour
Furniture	Per quote	
Linen	\$2.50	each
Microphones	\$25.00	each
Microphones, wireless	\$50.00	each
Internet Connection (Wireless)	Free (password needed)	
Internet Connection (hard wired)	\$100.00	each
Custom Internet Configuration	\$50.00	Half Hour
Phone Line	\$100.00	each
Pipe & Drape		
8' X 10' or 10' X 10' Booth (each)	\$40.00	each
8' X 10' or 10' X 10' Booth (10 or more)	\$25.00	each
Booth package (table/2chairs/linen/skirt)	\$30.00	each
Miscellaneous 8' Pipe and Drape	\$3.00	foot
Miscellaneous 3' Pipe and Drape	\$2.00	foot
Projection Screen	\$2,000.00	each
Projector	\$50.00	each
Risers	\$20.00	each
Table Skirts	\$12.50	each
Sound Equipment		
House Sound (includes microphone)	\$100.00	each
Portable system (mic, amp, speakers)	\$100.00	each
Full Audio System	Per quote	

Spot Lights	\$125.00	each
Staging / misc (full stage by quote)	\$40.00	each
Tables (client sets up)	\$6.00	each
Tables (DeltaPlex sets up)	\$7.00	each
Towels	\$2.00	each
Turnstiles	\$25.00	each
VCR / DVD player	\$25.00	each
White Board	\$20.00	each

Variable Costs	Rate	
Box Office Fee	3.5%	Gross Sales
Box Office Credit Card Fee	3.5%	Gross Credit Card Sales at Box Office
Facility Fee	\$2.50	Per ticket on certain events
Event Insurance	Available/quote	May be purchased through us
Parking (paid by customer)	Varies	Per car
Parking Buyout	Available/quote	Per Attendee paid by Client

Labor	Rate	Per
A/V Tech	\$25.00	hour
Paramedics & Ambulance (Two Medics) (minimum)	\$75.00	hour
EMT's (Two EMT's)	\$80.00	hour
Riggers	See Event Manager	
Stage Hands	See Event Manager	
Runners	\$175.00	day
Security, Day	\$15.50	hour
Security, Supervisor (1 for every 5-9 guards)	\$17.50	hour
Security, Manager (1 for every 10+ guards)	\$22.00	hour
Set/Strike/Clean-up	Per event	
Police (pair) (minimum)	\$120.00	hour
Usher/Ticket Taker	\$11.75	hour

Miscellaneous		
Catering	See Food & Beverage Manager	Varies
Clean-up	Per event	Varies
Damages	Per incident	Varies
Water Station	\$15.00	Per/day

